

The Estate Agent People Recommend



26 Jasmine Square,  
Woodley  
RG5 4BW



Wentworth Estate Agents have pleasure in offering to the market this stunning TWO BEDROOM COACH HOUSE with stairs leading to the first floor, situated within an ideal location on Woodley Airfield. This property MUST BE VIEWED to appreciate the light and spacious living space.

At the front of the property, has a stunning path to the front with flowers and shrubs on either side. On entering the property you are welcomed with a stunning and light entrance hall with space for shoes and coats at the bottom of the stairs. The stairs lead up to the first floor, carpeted throughout with the exception of the bathrooms and kitchen. Within the hallway there is a large cupboard for further storage and also loft access.

A modern kitchen with plenty of eye and base level units, with integrated washer/dryer, Integrated fridge/freezer, integrated dishwasher, 4 ring gas hob and electric oven.

An open plan living room that is adjoined to the kitchen creating a large light spacious living space.

Master Bedroom is a good size with fitted wardrobes and Ensuite with Aqualisa Shower, WC, sink and towel rail. The Ensuite is half tiled with a large mirror above the sink.

A further double bedroom and family bathroom, with a three piece white suite.

Further benefits include Gas radiator central heating, UPVC windows, a private covered parking space with further storage space and additional parking at the rear.

EPC - B

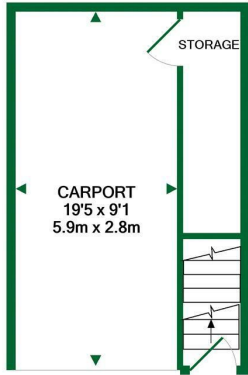

GROUND FLOOR  
APPROX. FLOOR  
AREA 244 SQ.FT.  
(22.7 SQ.M.)

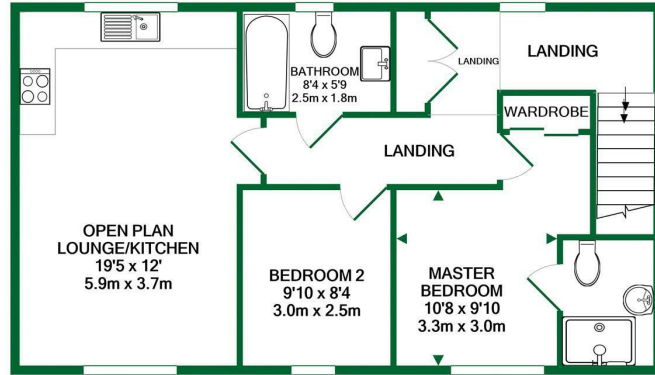

1ST FLOOR  
APPROX. FLOOR  
AREA 670 SQ.FT.  
(62.3 SQ.M.)

TOTAL APPROX. FLOOR AREA 914 SQ.FT. (84.9 SQ.M.)

Whilst every attempt has been made to ensure the accuracy of the floor plan contained here, measurements of doors, windows, rooms and any other items are approximate and no responsibility is taken for any error, omission, or mis-statement. This plan is for illustrative purposes only and should be used as such by any prospective purchaser. The services, systems and appliances shown have not been tested and no guarantee as to their operability or efficiency can be given  
Made with Metropix ©2020

## ACCOMMODATION

- STUNNING TWO BEDROOM COACH HOUSE
- STAIRS LEADING TO THE FIRST FLOOR
- SPACIOUS AND LIGHT LIVINGSPACE
- TWO BATHROOMS
- OPEN PLAN KITCHEN
- ALLOCATED COVERED PARKING
- FURTHER PARKING AT REAR
- FREEHOLD
- EPC - B

